

» Ring Lock«



- Comfortable and secure height adjustment using the locking pin
- Expanding mandrel \varnothing 35-36,5 mm, Height: 1010 - 1490 mm, Weight: 2.9 kg

Thank you for choosing this product. The instructions provide directions to all of the important set up and handling steps. We recommend you keep these instructions for future reference.

SAFETY NOTES

- a. Criteria for maximum load:
 - the proper installation setup consists of the following:
 - subwoofer, distance rod and satellite box may not fall over at a 5° testing angle
 - max. 35 kg
- b. Prior to use:
 - The floor must be load bearing and level
 - Check if the distance rod, loudspeakers and aids (e.g. ladders) are in working order, in particular regarding:
 - completeness, size relationship and quality
 - In the case of heavy loads the use of additional technicians is required. (we recommend 2 technicians that are physically fit)
- c. Safety during operation:
 - be sure the weight on the rod is centered:
 - if the weight is not centered - this has a negative affect on stability
 - Keep unauthorized individuals away from the installation
 - Ensure that the clamp screw **14** and the locking pin **12** are clicked into place
 - Never loosen the clamp screw or locking pin without having someone hold the weight of the subwoofer, loudspeakers, or satellite boxes
 - Protect against lateral forces.
 - These increase the risk of the installation falling over and also place undue strain on the subwoofer flange adapter.

Examples of lateral forces:

 - wind, impact, uneven surface, pulling on the installation
- d. After use:
 - first remove the satellite boxes,
 - then loosen the rod from the subwoofer
 - Careful and attentive handling is required:
 - the adjustment options can result in pinching or wedging your hands

SET UP INSTRUCTIONS

- 1** Remove the distance rod from the box and screw the clamp screw into the clamping bracket
- 2** Then turn both mandrel locking rings so that they are facing OPEN, to be able to set the system to the smallest diameter.
- 3** Spreizdorn bis zum Anschlag in die Flanschbuchse des Subwoofers stecken.
- 4** Turn the lower locking ring towards the right (Direction CLOSE) until the mandrel fits tight in the flange adapter.

TECHNICAL DATA / SPECIFICATIONS

Material	Tubes: Steel, black powder coating Locking Rings: aluminum Screws, locking pin: steel, galvanized, nickel plated Mandrel elements, handles: PA
Load Capacity	max. 35 kg / 5°
Dimensions	H: 1010 - 1490 mm Mandrel system: ø 35-36,5 mm - 100 mm
Box	1050 x 50 x 100 mm
Weight	2.9 kg
Accessories (optional)	Carrying Case 21421 (for one or two rods) Flange Adapters (19580, 19654, 19656) Screw On Flange (24281) Adapter Sleeve 21326: ø 38 mm (=US-Variant)

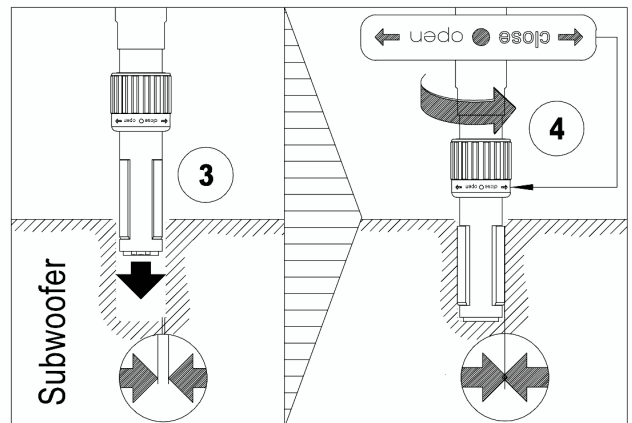
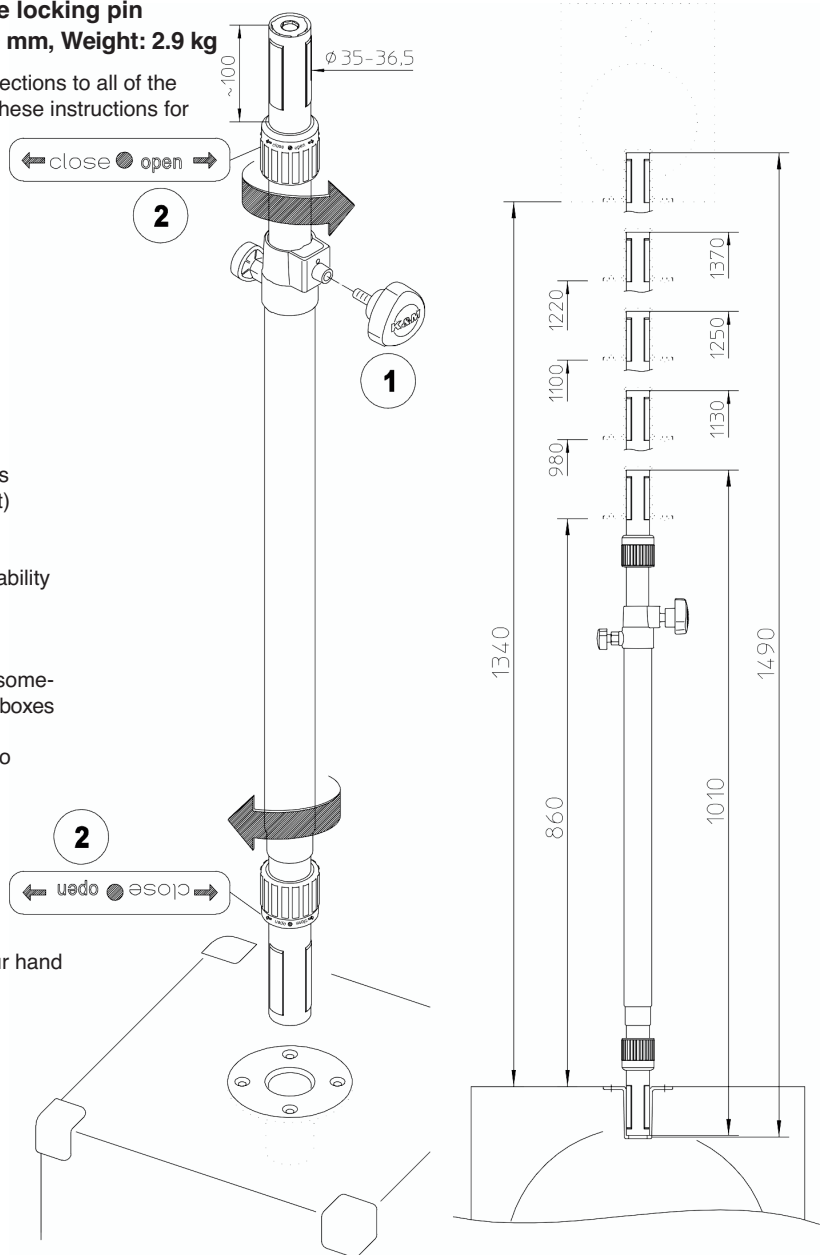

KÖNIG & MEYER GmbH & Co. KG
Kiesweg 2, 97877 Wertheim, www.k-m.de
21366-014-55 Rev.04 03-80-233-00 4/14

USAGE NOTES / FUNCTION

NOTE!

- Do not underestimate the weight of the loudspeaker
- placement and distance of the loudspeaker must be carried out by physically fit technicians,
- firmly grasp the distance rod when adjusting the height and locking in the locking pin.

ATTACH LOUDSPEAKER TO THE STAND

- Turn the Mandrel Locking Ring to the right (Direction OPEN), to be able to set the system to the smallest diameter.
- Place the loudspeaker on the rod (directly or with a K&M-Adapter).
- Now turn the locking ring to the left (Direction CLOSE) until the mandrels lock into place.

CHANGE THE DIRECTION OF THE LOUDSPEAKERS

- Open locking ring **5** and turn the loudspeaker in the desired direction.
Tighten locking ring **7** (Direction CLOSE).

MOVING THE WEIGHT

Technicians:

FP - First Person: operates the distance rod with the weight

SP - Second Person: operates the clamping bracket's clamping screw and locking pin

Order when extending the rod:

- FP - **8** holds the distance rod
- SP - **9** loosens the clamp screw and holds it
10 pulls the locking knob until the locking pin is no longer in the locked position
- FP - **11** extends the distance rod with the box to the desired approx. height;
NOTE: to find the pin hole easily, the locking pin should be placed just above the hole
- SP - **12** lets go of the locking knob, so that the pin can click into the distance rod
- FP - **13** slowly lowers the distance rod so that the locking pin locks into the hole
- SP - **14** tightens the clamping screw (manual strength is enough)

When retracting the distance rod the reverse order applies.

IMPORTANT: ensure that one person tightens the clamping screw **14** immediately in the event the second person is not able to hold the distance rod.

CHECK, MAINTENANCE, CLEANING

- Careful use of the distance rod maintains the use of the telescope and the load bearing functionality of the installation
- Perform workstation maintenance only without the subwoofer, loudspeaker and satellite box on the rod and watch for eventual risks (pinched fingers, impact, the rod falls over)
- To care for the product use a damp cloth and a non-abrasive cleaning agent

FAULT FINDING (F) and SOLUTION (S)

F: Installation is not stable:

- S: Ensure that the surface is even.
S: Tighten the mandrel's locking rings **7** and the clamping screws **14**.

F: Distance rod is not stable / retracts:

- S: Tighten the clamping screw **14**
S: Check locking pin **13** to see if it clicked into place

F: Loudspeaker sways back and forth on the locking pin

- S: Tighten locking ring **7**
S: Check loudspeaker connector (max. \varnothing 36 mm)
S: US loudspeaker connectors (\varnothing 38) always use adapter sleeve 21326

F: It is difficult to turn the loudspeaker

- S: Pick up the loudspeaker a bit when turning the loud speaker
S: Loosen the locking pin **5** somewhat

