

The 21S subwoofer

21S subwoofer

The 21S-SUB is a high performance subwoofer for use with the xS-Series and xA-Series loudspeakers. The cabinet houses a single long excursion 21" driver in a bass-reflex design. The large, specially shaped reflex port enables the 21S-SUB to achieve high Sound Pressure Levels from a cabinet with a small footprint. When operated in INFRA mode, the 21S-SUB can be used to complement other d&b subwoofers by extending the frequency response of the system down to 33 Hz. The 21S-SUB can ground stacked or flown in either orientation. It can be flown individually or in a cluster of two cabinets.

The enclosure is constructed from marine plywood with an impact resistant black paint finish. The front of the loudspeaker cabinet is protected by a rigid metal grill backed by an acoustically transparent foam. The top, bottom and rear panels each incorporate a pair of M10 threaded inserts for attaching d&b rigging hardware.

System data

Frequency response (-5 dB standard) 35 Hz - 105 Hz
 Frequency response (-5 dB INFRA mode) 33 Hz - 85 Hz
 Max. sound pressure (1 m, free field)¹
 with D20/30D 134 dB
 with D80 135 dB

Loudspeaker data

Nominal impedance 4 ohms
 Power handling capacity (RMS/peak 10 msec) 650/2600 W
 Components 1 x 21" driver
 Connections 1 x NL4
 screw terminal block
 Weight 54 kg (119 lb)

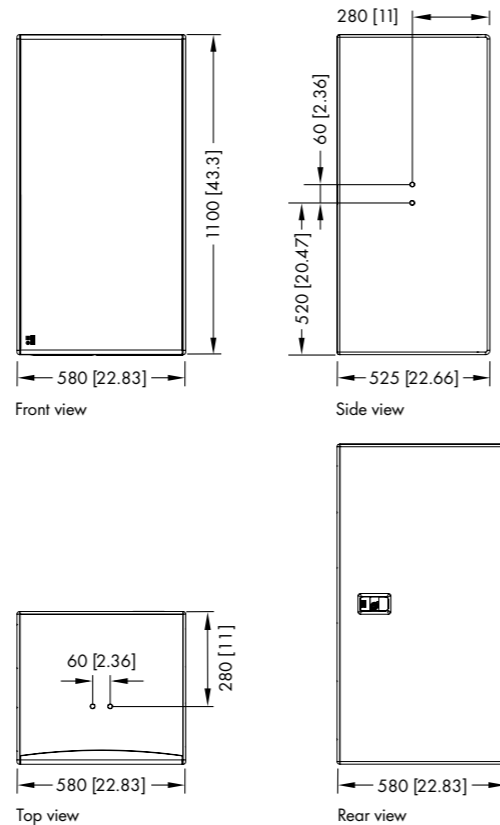

21S-SUB cabinet dimensions in mm [inch]

The 27S subwoofer

27S subwoofer

The 27S-SUB is a compact high performance cardioid subwoofer for use with the xS-Series and xA-Series loudspeakers. The cabinet houses two long excursion neodymium drivers in an integrated cardioid setup: a 15" driver in a bass-reflex design facing to the front and a 12" driver in a two chamber bandpass design radiating to the rear. The arrangement and tuning provide a cardioid dispersion pattern using a single amplifier channel. It can be used stand-alone, ground stacked or individually flown. The enclosure is constructed from marine plywood with an impact resistant black paint finish. The front of the loudspeaker cabinet is protected by a rigid metal grill backed by an acoustically transparent foam. The side panels incorporate a pair of M10 threaded inserts. The loudspeaker is Ball Impact Resistant according to DIN 18032-3 for sports and multipurpose halls.

System data

Frequency response (-5 dB standard) 40 - 140 Hz
 Frequency response (-5 dB 100 Hz mode) 40 - 100 Hz
 Max. sound pressure (single cabinet, 1 m, free field)¹
 with D6/10D 128 dB
 with 30D/D20 131 dB
 with D80 131 dB

Loudspeaker data

Nominal impedance 6 ohms
 Power handling capacity (RMS/peak 10 msec) 500/2000 W
 Components front/rear 15"/12" driver with neodymium magnet
 Connections 2 x NL4
 screw terminal block
 Weight 41 kg (90 lb)

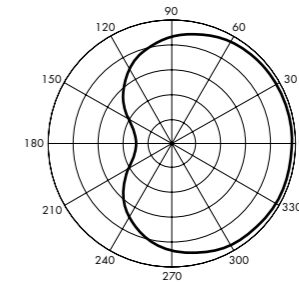

Cardioid polar pattern

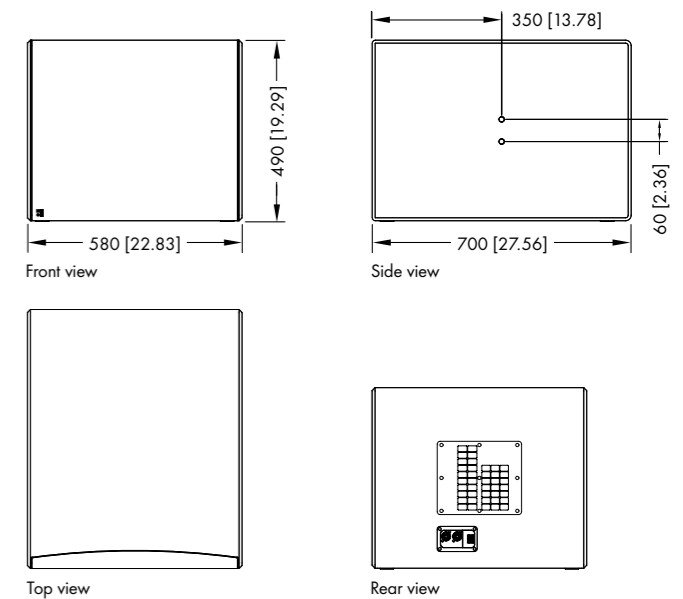

27S-SUB cabinet dimensions in mm [inch]